

Model NO : #CDF105B L \*\*\*

**Features**

- \* low profile, high power, low dcr .
- \* compact size with high performance core structure.
- \* green product version.
- \* custom designs available.
- \* closed magnetic circuit construction for high density board assembly .



**Application**

- \* notebook PC ,
- \* modem equipmet,
- \* LCD,OA equipment,
- \* other electronic equipment

**Electrical characteristics**

parts No	D.C.R(Ω) MAX	Rated current A※3	parts No	D.C.R(Ω) MAX	Rated current A※3	parts No	D.C.R(Ω) MAX	Rated current A※3
1R2	6m	5.50	101	182m	660m			
1R8	8m	4.20	151	302m	500m			
2R7	11m	3.70	221	384m	450m			
3R9	13m	3.00	331	559m	360m			
6R8	18m	2.30	471	780m	300m			
100	22m	2.00	681	1.07	240m			
150	34m	1.70	102	1.59	200m			
220	43m	1.40						
330	61m	1.15						
470	92m	940m						
680	120m	790m						

**NOTE :**

- ※1. Measuring Frequency (F) :  $L \leq 8.2\mu\text{H}$  100KHZ/0.25V  $L \geq 10\mu\text{H}$  1KHZ/0.25V
- ※2. Tolerance of Inductance :  $L \leq 8.2\mu\text{H}$   $\pm 30\%$   $L \geq 10\mu\text{H}$   $\pm 20\%$
- ※3. Rated Current : This indicates the value of current when the inductance is 35% lower than its initial value at D.C.superposition or D.C.current when  $\Delta T=40^\circ\text{C}$  whichever is lower .(Ta=20°C)
- ※4. Inductance value . 1R0:1.0(uH) ; 100:10(uH) ; 101:100(uH) ; 102:1000(uH) ;

**Physical dimension : (UNIT:mm)**

TYPE	A $\pm 0.4$	B $\pm 0.4$	C(max)	D	E	F	G	H
#CDF105B	10.00	9.00	5.50	3.20	4.50	2.50	4.50	9.50

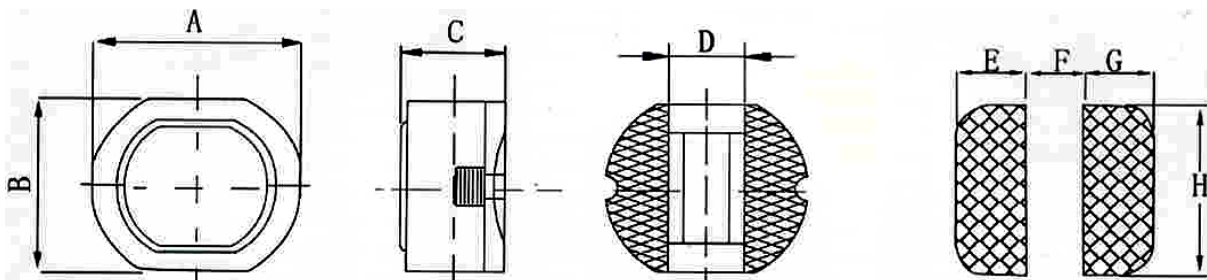

PCB pattern

Please refer to the sales offices on our website for a representative near you

URL: <http://www.selmag.com.cn>